

Professional Light Dimmer PD-2

Product Description-Function

The surface mounting dimmer PD-2 is a 230V a.c./50Hz voltage regulator, specifically designed to fulfill the needs of indoor lighting adjustment. It is suitable for controlling **LED** lamps Dimmable, any type of 230V incandescent bulbs (resistive or halogen lamps), or 12-36V lamps with transformer (inductive loads) up to 2500W.

It is designed with a "Soft Start" function, which provides maximum protection for the lamps.

The dimmer has a potentiometer, for adjusting the power consumption, from 1% to 100%, and an ON/OFF rocker switch for turning the load ON or OFF.

It also has a trimmer for adjusting the lower limit.

The dimmer is in conformity with provisions of directives and international standards EN 60669- 1: 2000, EN 60669-2-1 : 2002 2014/35/EU, 2014/30/EU.

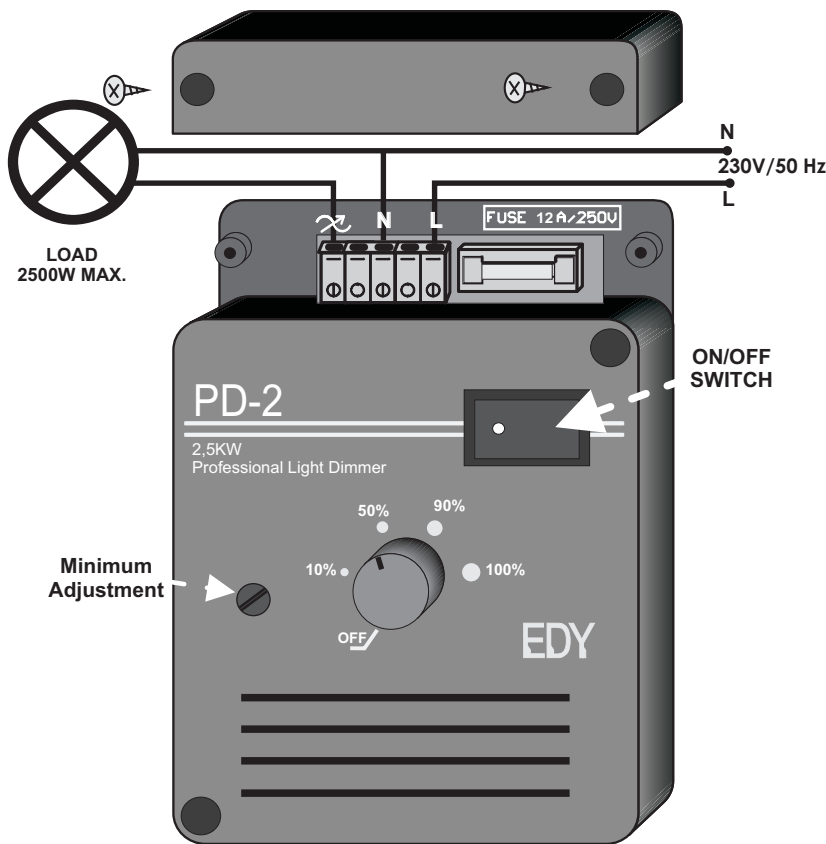

Connection

The device must be connected by a qualified technician.

Remove the protective cover and connect the 230V power supply and the load to the connecting terminals. After connecting, the protective cover must be repositioned.

Precautions

The device must be placed in a location with difficult access for children. It must be secured indoors, protected from excessive moisture (vapors) and heat (radiators). The ventilation slots of the device must remain uncovered.

CAUTION: The switch does not isolate the power line, only the drive circuit.

Technical specifications

Operating voltage	230 Volts a.c. / 50Hz
Load	3 W - 2500 W resistive/ inductive 400W Led
Protection from short circuit / overload	Glass fuse 5x20mm 12A / 250V
Operating temperature	-10 °C to +60 °C
Maximum humidity	95 %
Construction material	ABS
Dimensions	120mm x 85mm x 35mm



IP 20



Made in Greece

The company reserves the right to change the features for the purpose of improving the product.